









MONTAGEANLEITUNG

-  MONTAGEANLEITUNG
-  ASSEMBLY INSTRUCTION
-  DE INSTRUCTIE VAN DE ASSEMBLAGE
-  ISTRUZIONE DI MONTAGGIO
-  INSTRUCCIÓN DE ASAMBLEA
-  INSTRUCTION DE MONTAGE
-  NÁVOD K MONTÁŽI
-  MONTERINGSANVISNING

-  MONTAJ TALIMATI
-  ASENNUSOHJE
-  BRUGSANVISNING
-  BRUKSANVISNING
-  UPUTE ZA MONTAŽU
-  NAVODILA ZA MONTAŽO
-  SZERELÉSI ÚTMUTATÓ
-  INSTRUCTIUNI DE MONTAJ

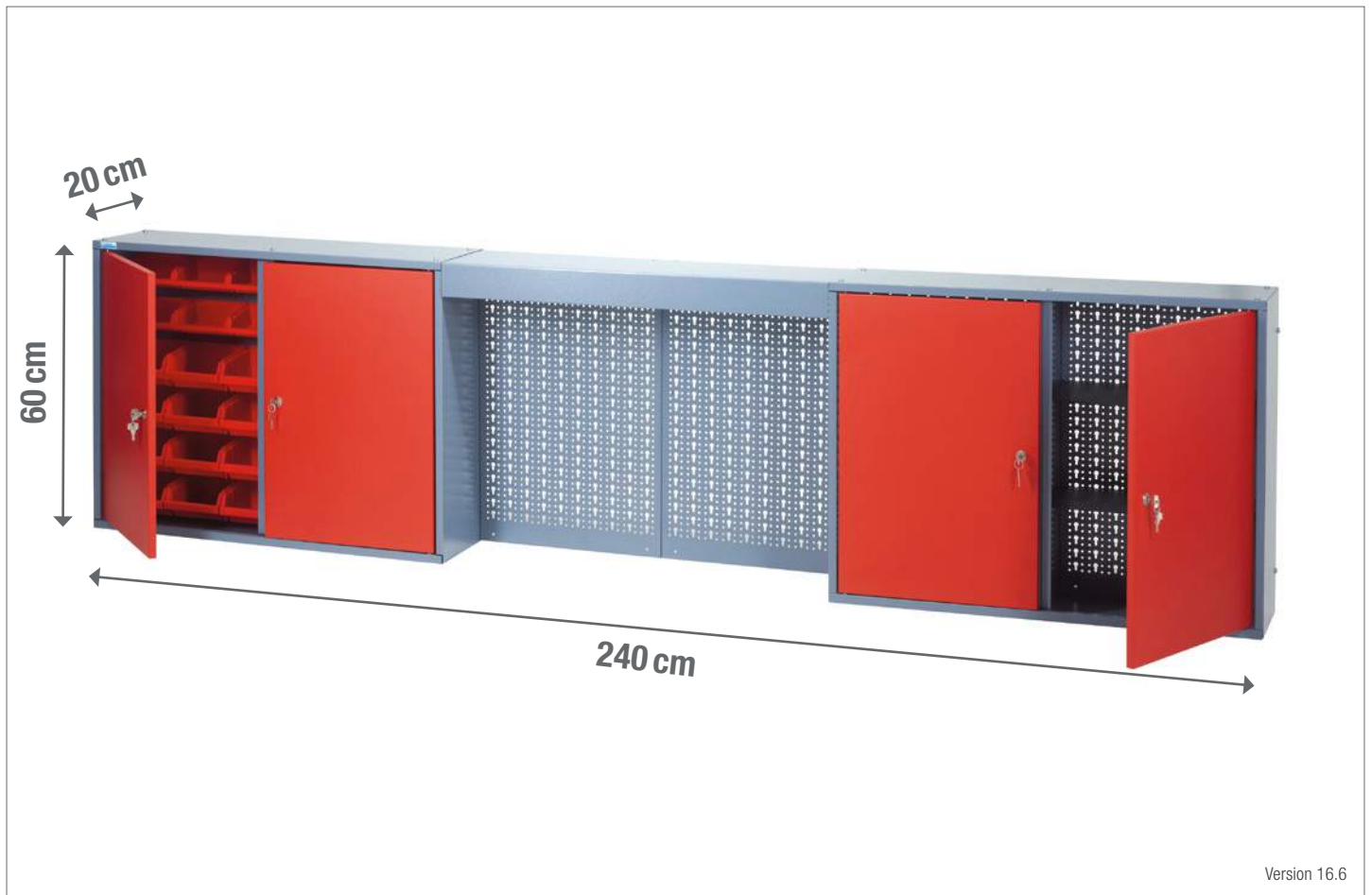

Version 16.6

Modell-Nr.

**70180**

ART.-NR. FRONT KORPUS

70182 **Rot** (ähnl. RAL 3002) Silber

70187 **Ultramarinblau** (RAL 5002) Silber

70186 Silber **Schwarz** (RAL 9005)

Friedrich Küpper  
Friedrich-Küpper-Weg  
54570 Berlingen  
Deutschland

Telefon +49 (0) 65 91 - 95 42 0  
Telefax +49 (0) 65 91 - 95 42 17  
E-Mail [info@friedrich-kuepper.de](mailto:info@friedrich-kuepper.de)  
Internet [www.friedrich-kuepper.de](http://www.friedrich-kuepper.de)

## EINZELTEILE / PIECES

4× **B**



800 mm × 200 mm

Art.-Nr. E0310 (Silber/silver)  
Art.-Nr. E0311 (Schwarz/black)

1× **D**



850 mm × 200 mm

Art.-Nr. E0312 (Silber/silver)  
Art.-Nr. E0313 (Schwarz/black)

4× **E**



600 mm × 200 mm

Art.-Nr. E0315 (Silber/silver)  
Art.-Nr. E0316 (Schwarz/black)

2× **G**



600 mm × 180 mm

Art.-Nr. E0323 (Silber/silver)  
Art.-Nr. E0324 (Schwarz/black)

4× **J**

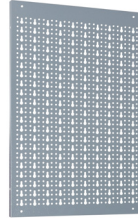

595 mm × 400 mm

Art.-Nr. E0331 (Silber/silver)

2× **K**



595 mm × 400 mm

Art.-Nr. E0334 (Silber/silver)

4× **M**



560 mm × 375 mm

Art.-Nr. E0344 (Silber/silver)  
Art.-Nr. E0341 (Rot/red)  
Art.-Nr. E0343 (Blau/blue)

4× **P**



393 mm × 138 mm

Art.-Nr. E0365 (Schwarz/black)

12× **Q**



130 mm × 100 mm × 50 mm

Art.-Nr. 841 (Rot/red)  
Art.-Nr. 844 (Grau/grey)

24× **R**



130 mm × 130 mm × 70 mm

Art.-Nr. 842 (Rot/red)  
Art.-Nr. 845 (Grau/grey)

## BEUTELINHALT / BAG CONTENT



## BENÖTIGTES WERKZEUG / NEEDED TOOLS

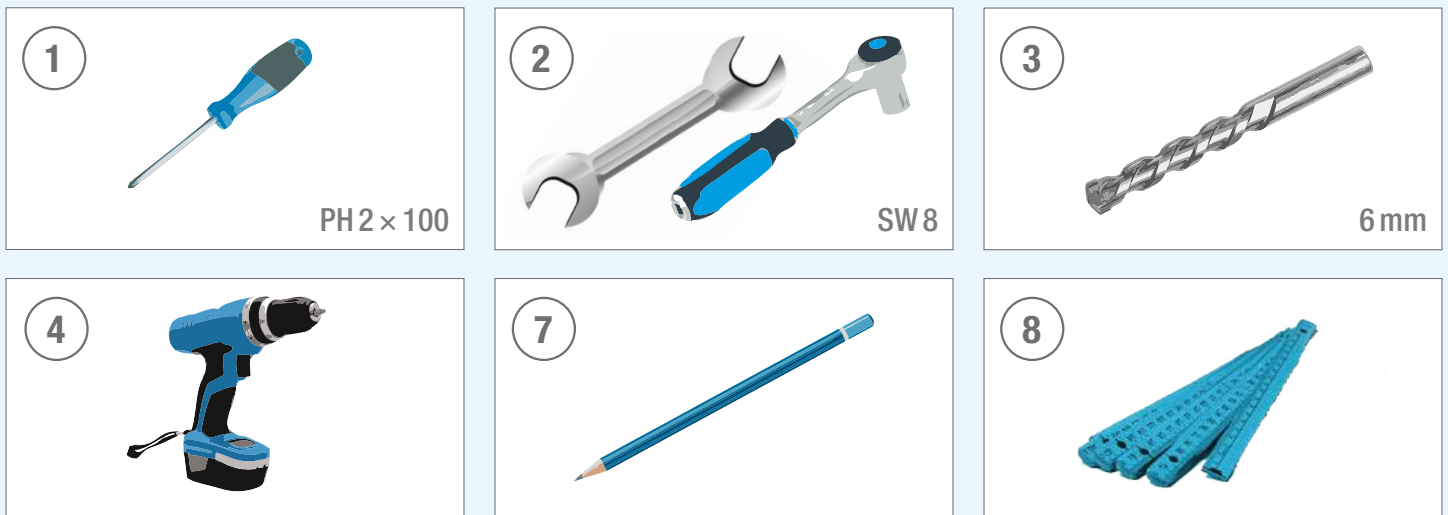

1.



2.

2 × M5

2 × M5 × 10

2 × 5,3 mm

② SW8

① PH2×100

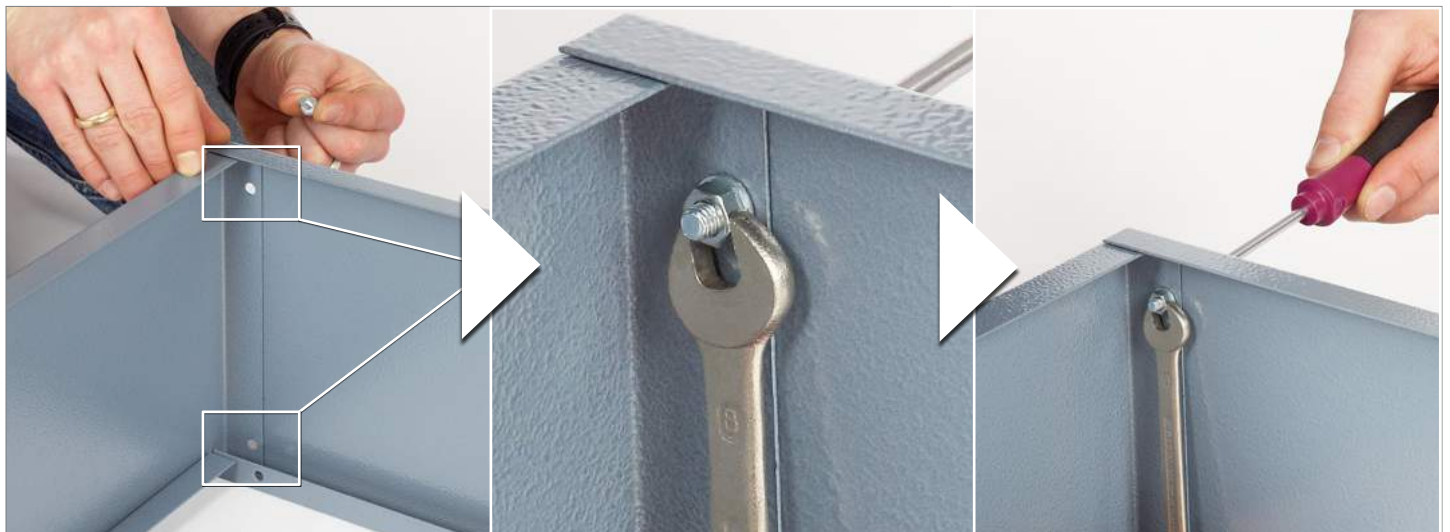



3.



4.





-  1 × M5
-  1 × M5 × 10
-  1 × 5,3 mm
-  ② SW8
-  ① PH2 × 100

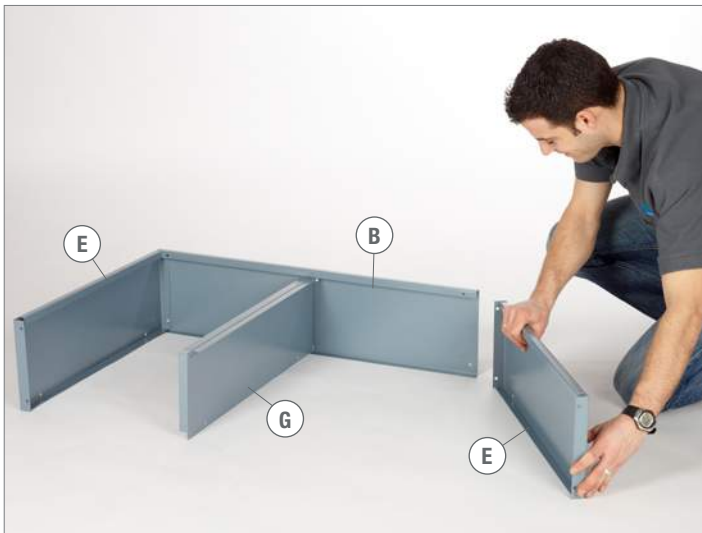

5.



6.

-  2 × M5
-  2 × M5 × 10
-  2 × 5,3 mm
-  ② SW8
-  ① PH2 × 100



WIEDERHOLEN SIE DIE SCHRITTE 1-6 / REPEAT STEPS 1-6

7.

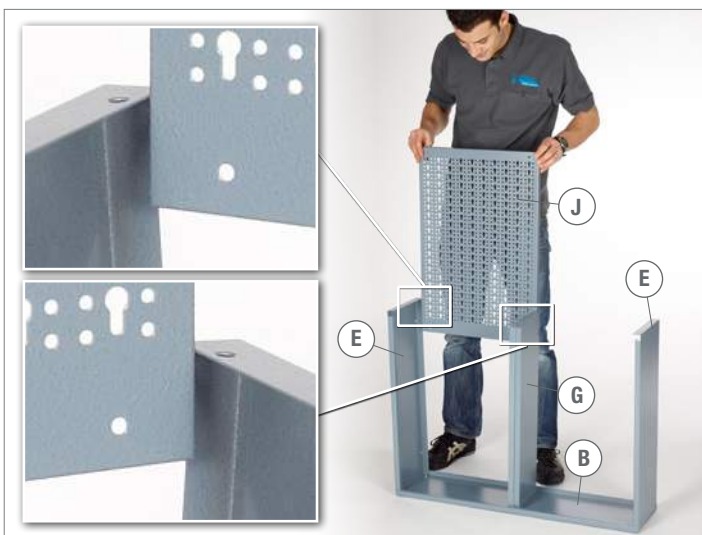

8.

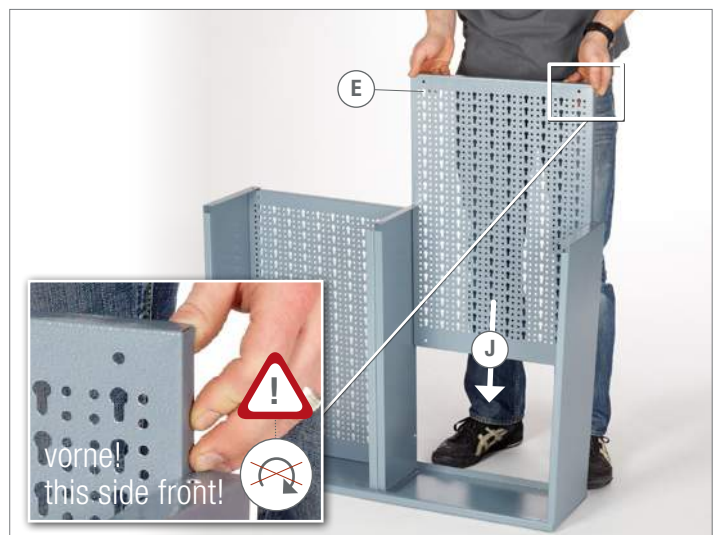

9.

2 × M5 2 × M5 × 10 2 × 5,3 mm ② SW8 ① PH2 × 100



10.

2 × M5 2 × M5 × 10 2 × 5,3 mm ② SW8 ① PH2 × 100

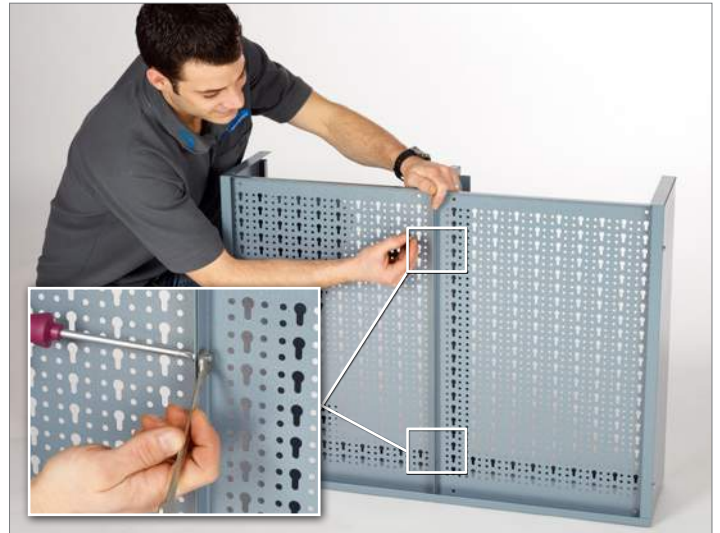

11.

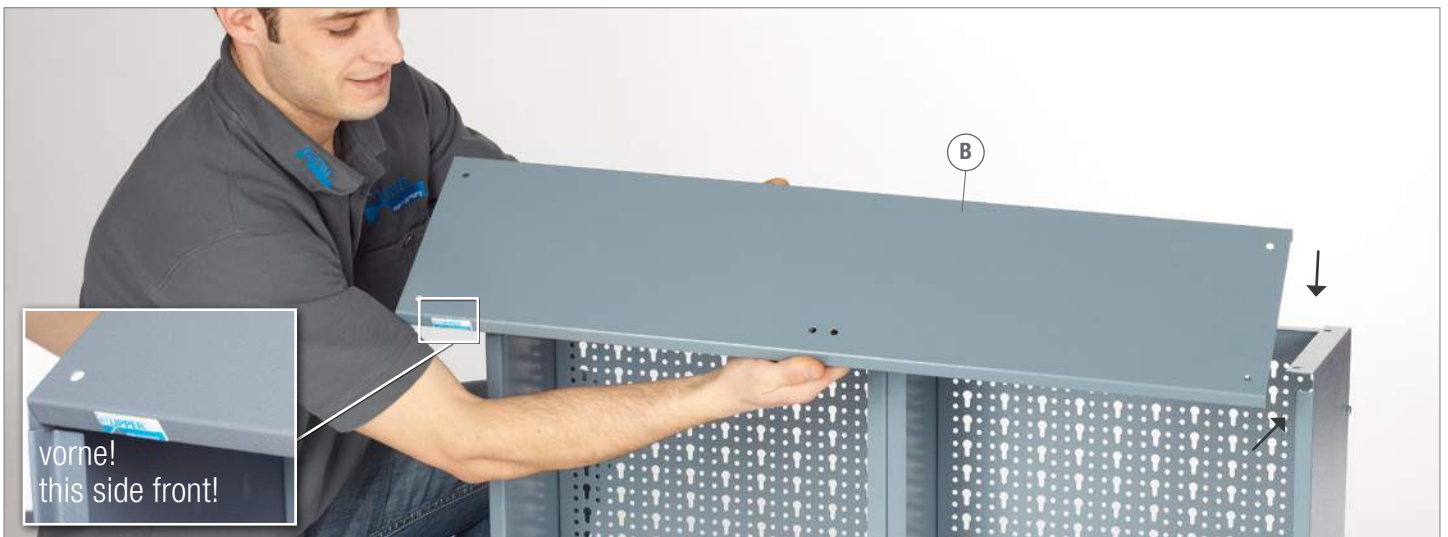

12.

3 × M5 3 × M5 × 10 3 × 5,3 mm

② SW8 ① PH2 × 100

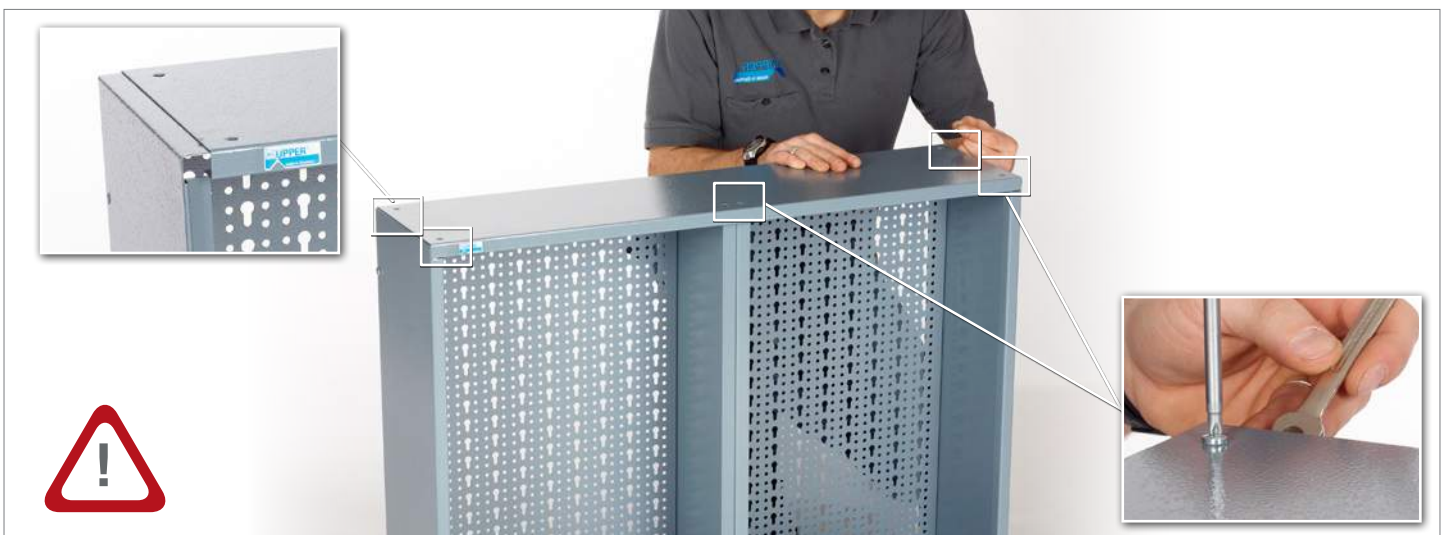



13.

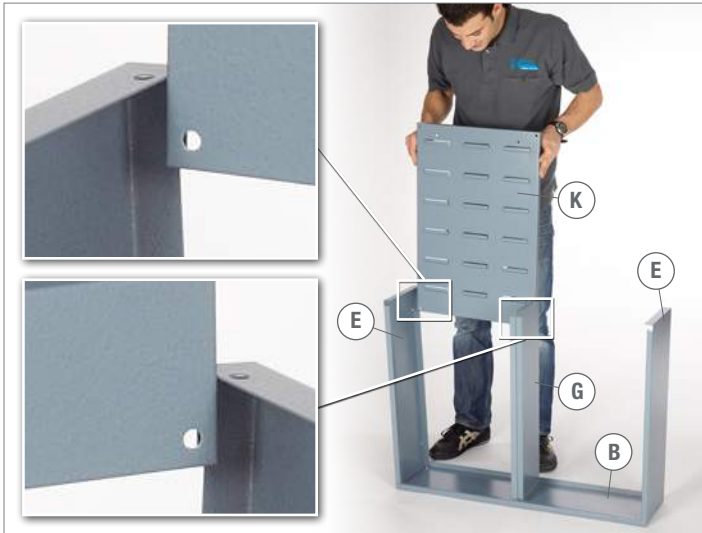

14.

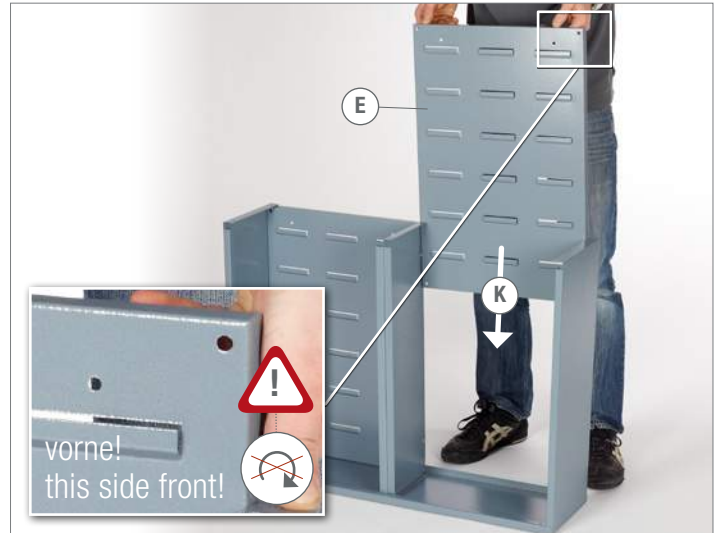

15.

- 2 x M5
- 2 x M5 x 10
- 2 x 5,3 mm
- 2 SW8
- 1 PH2x100



16.

- 2 x M5
- 2 x M5 x 10
- 2 x 5,3 mm
- 2 SW8
- 1 PH2x100

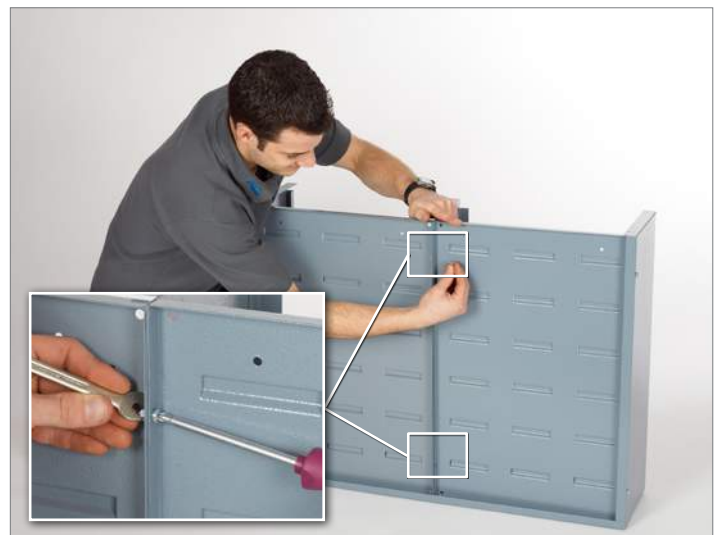

17.



18.

- 3 x M5
- 3 x M5 x 10
- 3 x 5,3 mm
- 2 SW8
- 1 PH2x100



19.

2 × M5

2 × M5 × 10

2 × 5,3 mm

②  SW8

①  PH2×100



20.

2 × M5

2 × M5 × 10

2 × 5,3 mm

②  SW8

①  PH2×100

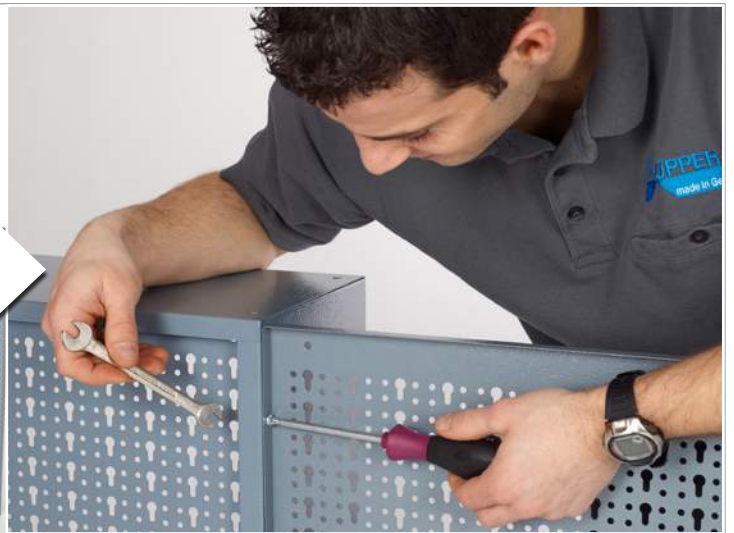

21.

2 × M5

2 × M5 × 10

2 × 5,3 mm

②  SW8

①  PH2×100





22.



23.

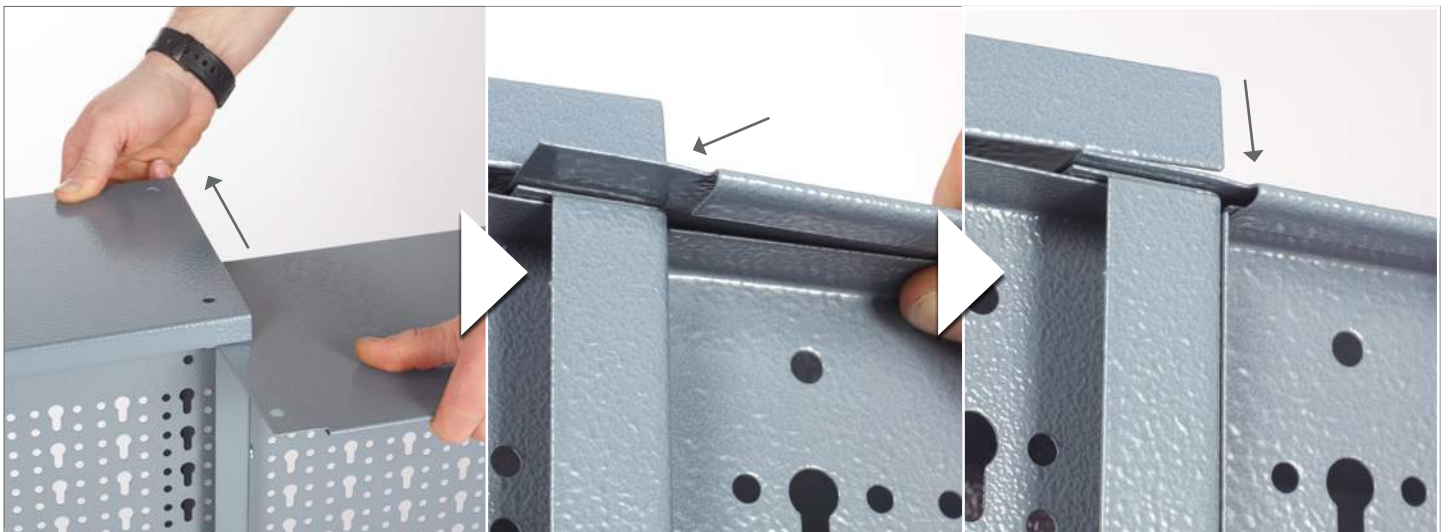

24.

4 × M5

4 × M5 × 10

4 × 5,3 mm

②  SW8

①  PH2×100

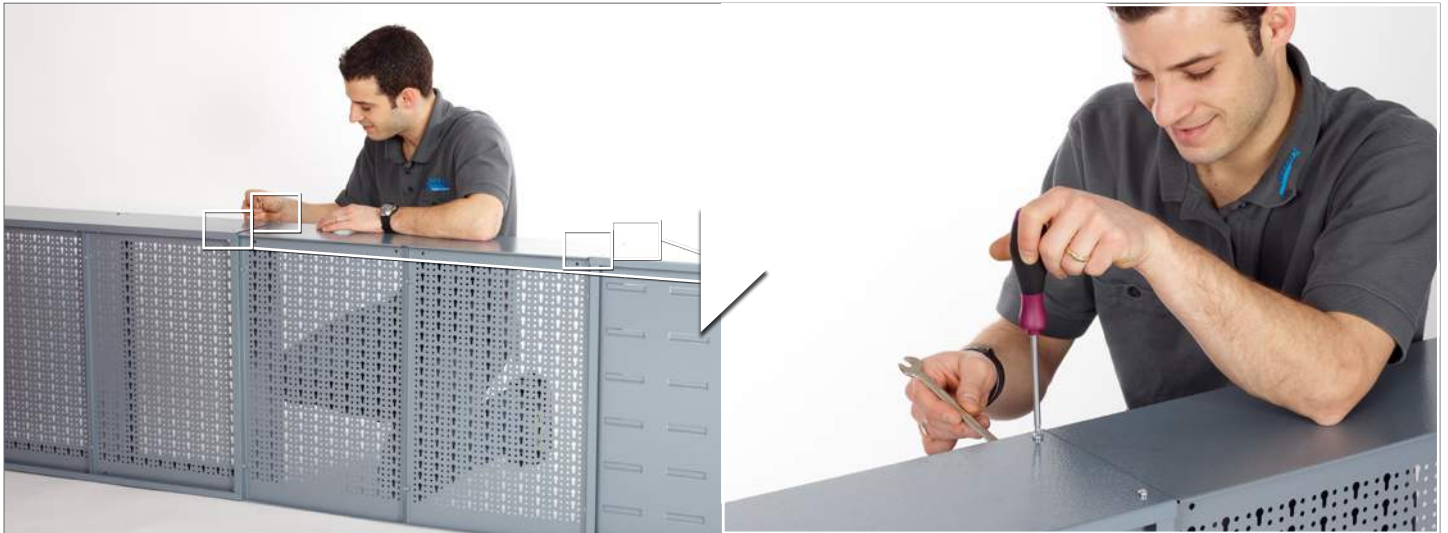

25.

②  SW8

①  PH2×100





26.  8x





27.



28.

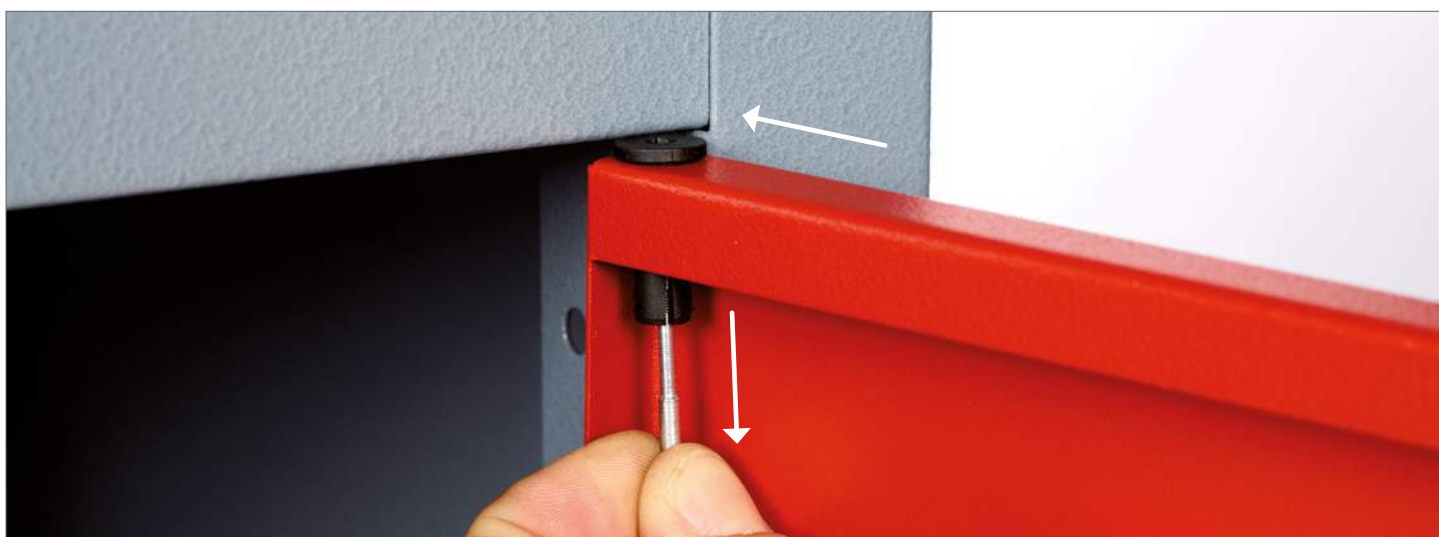

29.



30.



31.





32.



A.  

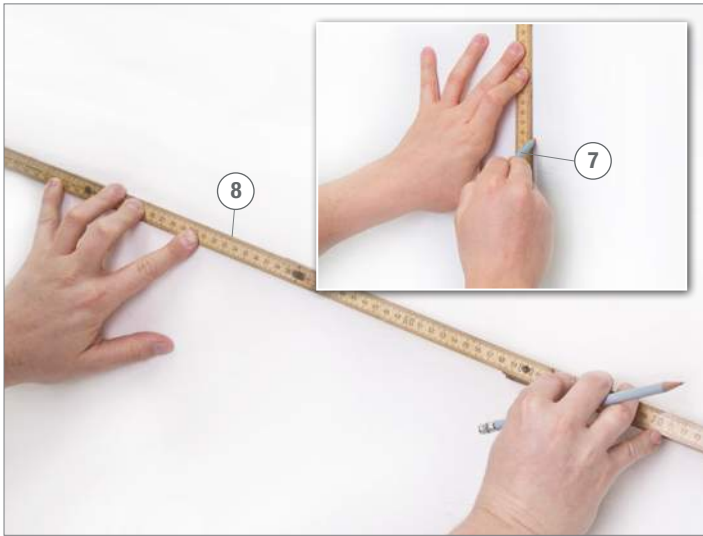

B.  8 x 6 mm  



C.  8 x 4,5 x 60  8 x 15 x 15

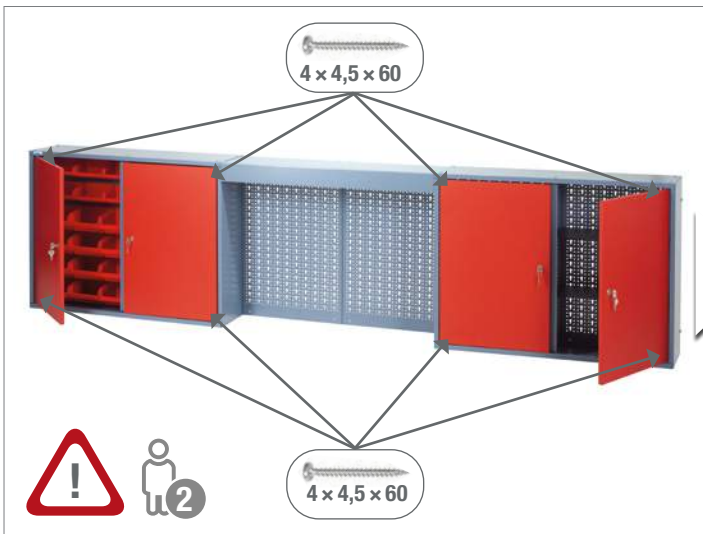

Modell-Nr.

**70180**